

REVISION
1. ADDED SHADE SCREENING

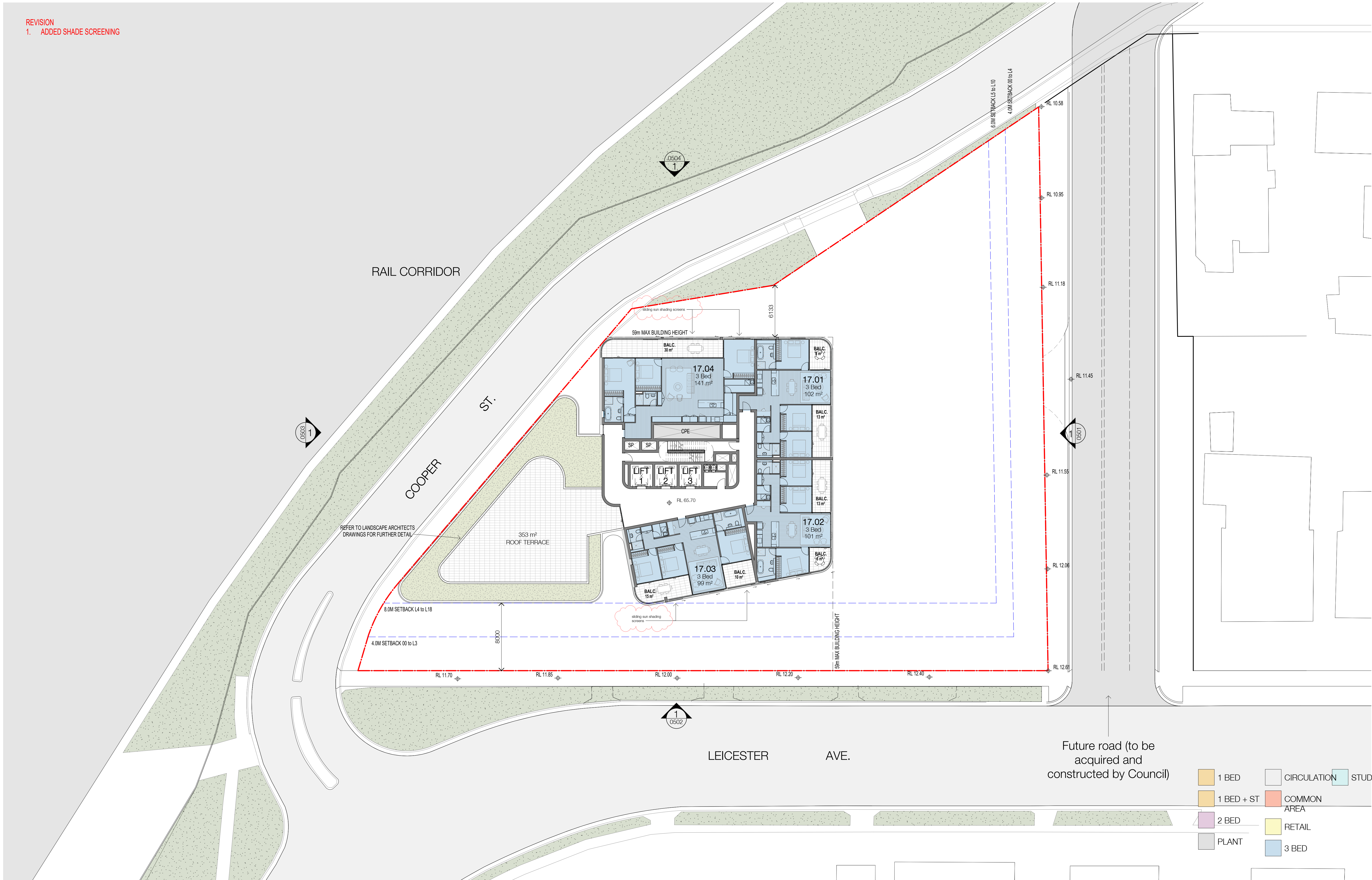

In accepting and utilising this document the recipient agrees that SJB Architecture (NSW) Pty. Ltd. ACN 081 094 724 T/A SJB Architects, retain all common law, statutory law and other rights including copyright and intellectual property rights. The recipient agrees not to use this document for any purpose other than its intended use, to waive all claims against SJB Architects resulting from unauthorised changes, or to reuse the document on other projects without prior written consent from SJB Architects. Under no circumstances shall transfer of this document be deemed a sale. SJB Architects makes no warranties of fitness for any purpose. The Builder/Contractor shall verify job dimensions prior to any work commencing. Use figured dimensions only. Do not scale drawings.

Nominated Architects: Adam Haddow-7188 | John Pradel-7004

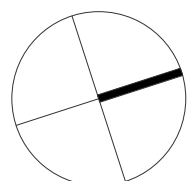

0 2 4 10m
1:200 @A1

Rev	Date	Revision	By	Chk.
4	19.08.2020	ISSUED FOR COORDINATION	BR	JT
5	28.08.2020	ISSUED FOR COORDINATION	BR	JT
7	11.09.2020	DRAFT DA ISSUE	BR	JT
8	16.09.2020	DRAFT DA ISSUE	BR	JT
9	22.09.2020	DA ISSUE	BR	JT
10	17.08.2021	FOR INFORMATION	JG	NH
11	20.09.2021	LEC INFORMATION		
12	23.09.2021	LEC UPDATES		

Client

LEICE PTY LTD

Project

2-10 LEICESTER AVE
STRATHFIELD NSW 2135
Drawing Name
FLOOR PLAN L17

Date

23.09.2021

Scale

1 : 200

Sheet Size

@ A1

Drawn

BR

Chk.

JT

Job No.

6242

Drawing No.

DA-0227

Revision

/ 12

SJB Architects
L2, 490 Crown St
Surry Hills NSW
2010 Australia
T 61 2 9380 9911
www.sjb.com.au

